

NEW PRODUCT



SAUTER front PROFLEKTOR



BALLASTING and **SAFETY** by a clever combination

subject to design changes, errors and mistakes excepted !

Hans Sauter GmbH • Auerbachweg 13 • D-87778 Stetten • Tel.: +49 8261 / 75994-0 • Fax: 75994-20
www.sauter-stetten.com • Instagram: [sauter_frontsysteme](https://www.instagram.com/sauter_frontsysteme)

- ↗ simple assembly at front linkage
- ↗ active & passive safety
- ↗ level tabs as maneuvering aid
- ↗ top link not in use (stays available)
- ↗ reflective warning foil (accord. to ECE104)
- ↗ combinable with many front devices and weights / front linkage stays usable
- ↗ stable & modular steel construction
- ↗ better perception through day & night
- ↗ significant reduction regarding risk of collision with cyclists, pedestrians and other road users
- ↗ available for Sauter front linkages & for diverse OEM front linkages (e.g. SDF, John Deere, CNH,...)



technical data:

<i>total width (with outline lights):</i>	<i>adjustable*, 2.25m – 2.65m or 2.35m – 2.75m (depending on tractor type)</i>
<i>total width (outer sheet metal):</i>	<i>adjustable*, 2.10m – 2.50m or 2.20m – 2.60m (depending on tractor type)</i>
<i>lighting:</i>	<i>LED outline lights (position / ending / side marking light)</i>
<i>colours:</i>	<i>red RAL 3002 or cost-neutral in tractor colour (special painting on request)</i>
<i>electricity / lighting:</i>	<i>simple pluggable / 7-pin plug inclusive</i>
<i>modular construction:</i>	<i>exchangeable parts (e.g. exchangeable „wings“)</i>

**stepless and tool-free adjustable*

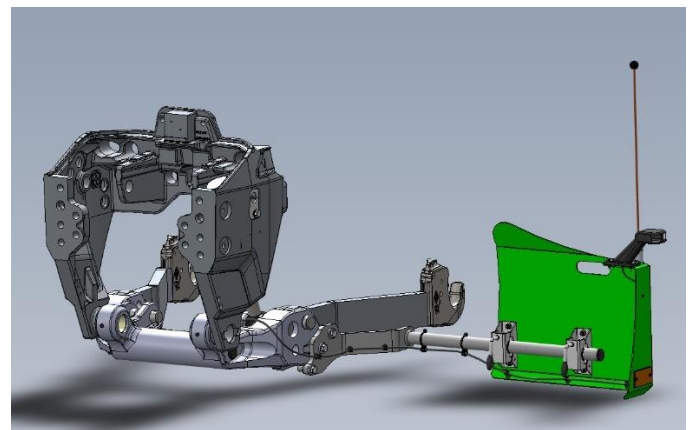
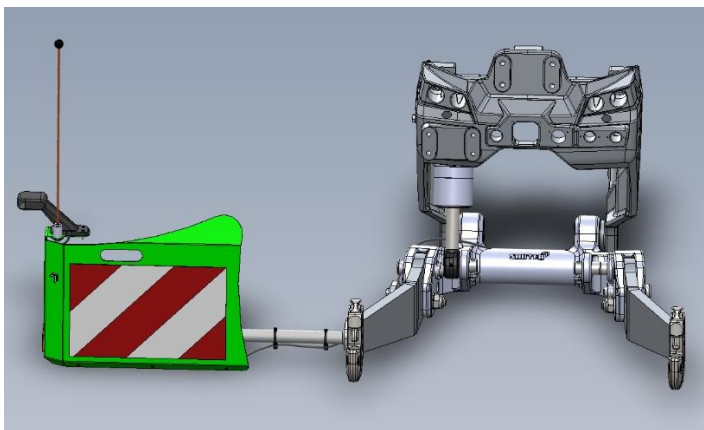

Let us be good examples – let’s make the road a safer place



subject to design changes, errors and mistakes excepted !

Hans Sauter GmbH • Auerbachweg 13 • D-87778 Stetten • Tel.: +49 8261 / 75994-0 • Fax: 75994-20
www.sauter-stetten.com • Instagram: [sauter_frontsysteme](https://www.instagram.com/sauter_frontsysteme) 